

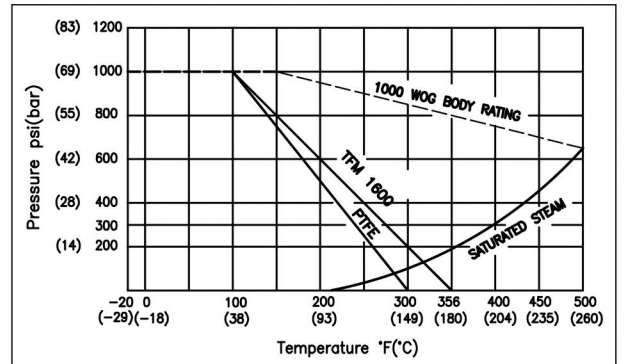

- MODEL NO: GKV-33L
- . BLOW-OUT PROOF STEM
  - . STAINLESS STEEL BALL AND STEM ARE STANDARD
  - . PRECISION INVESTMENT CAST BODY AND CAPS
  - . EASY INSTALLTION WITH WIDE SELECTION OF END FITTINGS
  - . THREE-PIECE SWING-OUT DESIGN ALLOWS IN-LINE MAINTENANCE
  - . FULL PORT ORIFICE MINIMIZES PRESSURE DROP ACROSS THE PIPELINE
  - . SELE-ADJUSTING FLOATING BALL ENABLES TIGHT INTERNAL SEAL

SIZE	ØID	ØED	L	C	H
1/4"	4.6	6.49	65.4	103	53
3/8"	7.5	9.7	65.4	103	53
1/2"	10.2	12.9	72.2	103	58
3/4R"	15	19.2	76.2	103	58
1R"	20	25.55	85.4	128	63

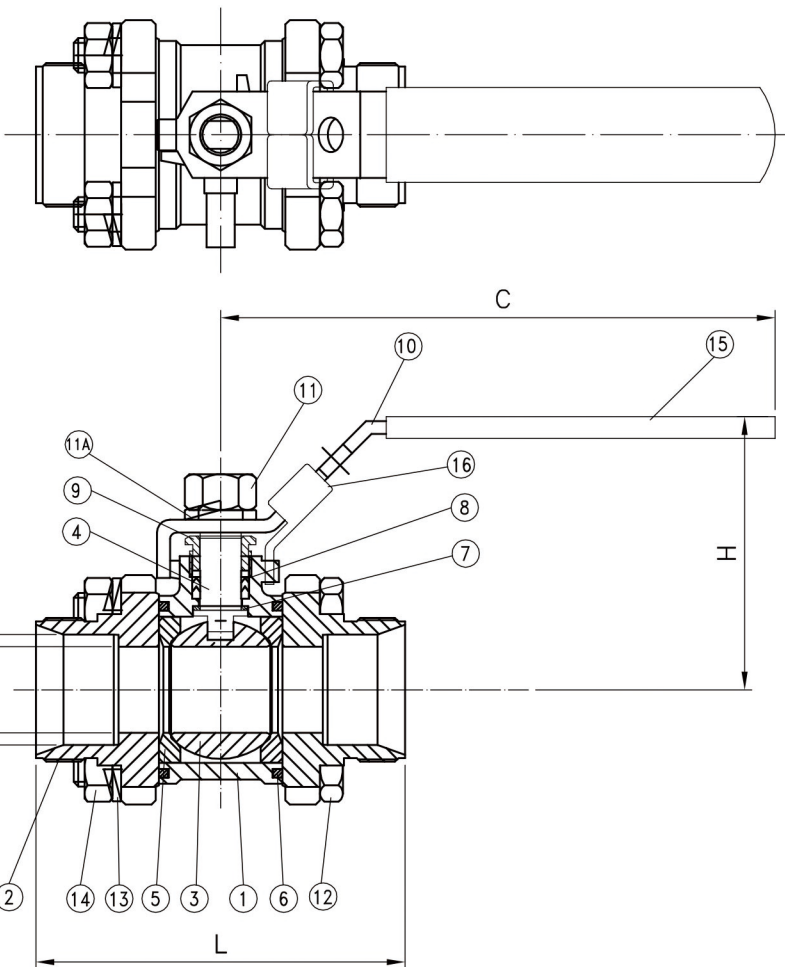

ITEM	Name	Material	Qty.
1	Body	CF8M	1
2	End Cap (lok)	CF3M/CF8M	2
3	Ball	CF8M	1
4	Stem	SS316	1
5	Ball Seat	TFM1600/PTFE	2
6	Body Seal	PTFE.TEFLON	2
7	Thrust Washer	PTFE.TEFLON	1
8	Stem Packing	PTFE.TEFLON	1
9	Stem Nut	SS304	1
10	Handle	SS304	1
11	Handle Nut	SS304	1
11A	Handle Washer	SS304	1
12	Body Bolt	SS304	4
13	Bolt Washer	SS304	4
14	Bolt Nut	SS304	4
15	Handle Sleeve	VINYL	1
16	Locking Device	SS304	1